

APPLIES TO MODELS: LA618-2, LA618-4, LA618-5

GENERAL SAFETY INFORMATION

- ♦ To reduce the risk of death, personal injury or property damage from fire, electric shock, falling parts, cuts/abrasions, and other hazards read all warnings and instructions included with and on the fixture box and all fixture labels.
- ♦ Before installing, servicing, or performing routine maintenance upon this equipment, follow these general precautions.
- ♦ Commercial installation, service and maintenance of luminaires should be performed by a qualified licensed electrician.
- ♦ To prevent wiring damage or abrasion, do not expose wiring to edges of sheet metal or other sharp objects.
- ♦ Do not make or alter any open holes in an enclosure of wiring or electrical components during kit installation.
- ♦ **DO NOT INSTALL DAMAGED PRODUCT!**
- ♦ This fixture is intended to be connected to a properly installed and grounded UL listed junction box.
- ♦ Suitable for Dry or Damp locations

WARNING: RISK OF ELECTRICAL SHOCK

- ♦ Turn off electrical power at fuse or circuit breaker box before wiring fixture to the power supply.
- ♦ Turn off the power when you perform any maintenance.
- ♦ Verify that supply voltage is correct by comparing it with the luminaire label information.
- ♦ Make all electrical and grounded connections in accordance with the National Electrical Code and any applicable local code requirements.
- ♦ All wiring connections should be capped with UL approved wire connectors.

CAUTION: RISK OF INJURY

- ♦ Wear gloves and safety glasses at all times when removing luminaire from carton, installing, servicing or performing maintenance.
- ♦ Avoid direct eye exposure to the light source while it is on.
- ♦ Account for small parts and destroy packing material, as these may be hazardous to children.

CAUTION: RISK OF FIRE

- ♦ Keep combustible and other materials that can burn away from luminaire and lamp/lens.
- ♦ MIN 90°C SUPPLY CONDUCTORS.

SAVE THESE INSTRUCTIONS

Use only in the manner intended by the manufacturer. If you have any questions, contact the manufacturer. Each luminaire is to be used with inside driver kit. Wiring to be performed by qualified electrician only.

SUSPENDED INSTALLATION

APPLIES TO MODELS

LA618-2, LA618-4, LA618-5

- Step 1:** Accessories
- Step 2:** Drill hole in the ceiling, push the rubber plug into the ceiling, fix the fixing head 2 in the ceiling with 4X30PA screw.
- Step 3:** A. Suspended method on the left: thread the square-head screw through fixing hole of safety rope, clamp and 8-figure buckle, and fixed with sewing machine
B. Suspended method on the right: thread the square-head screw through fixing hole of safety rope, clamp, and fixed with sewing machine.
- Step 4:** A. Suspended method on the left: thread the power wire through 8-figure buckle fixed on the left, then install the whole set of fixing clip on the lamp;
B. Suspended method on the right install the clip on the lamp.
- Step 5:** Fix the fixing head 1 with fixing head 2 tightly, and adjust suspended rope with sewing machine to balance the lamp, finally connect input wire of lamp.

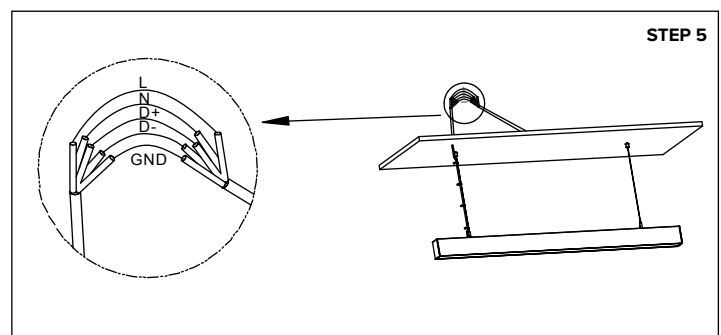
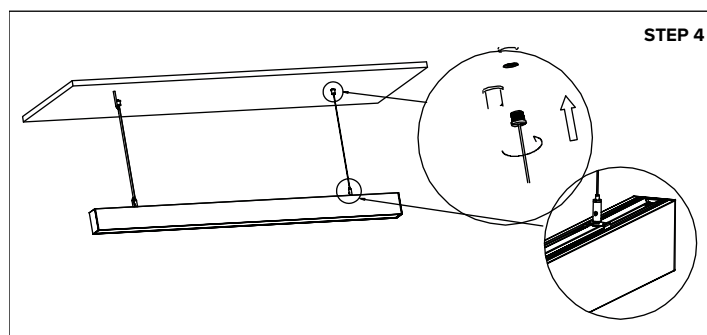
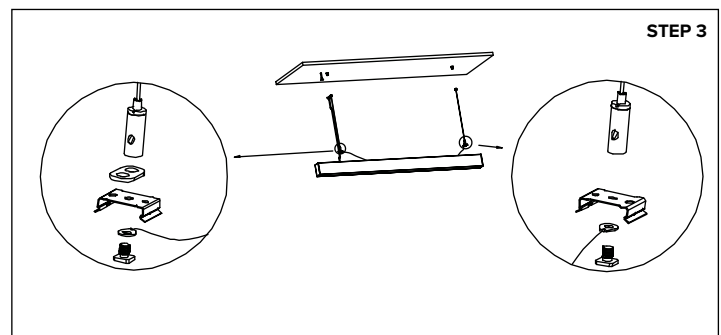
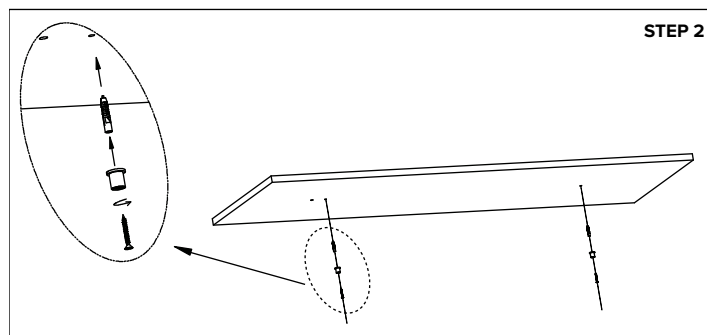
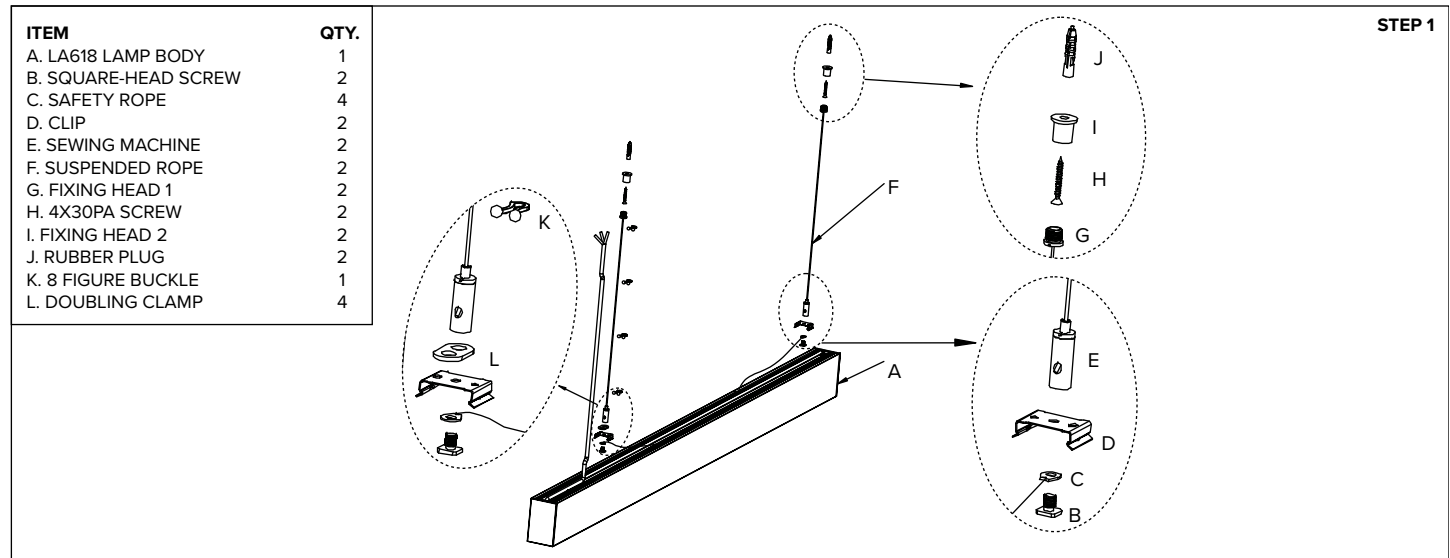

CEILING SURFACE MOUNT INSTALLATION

APPLIES TO MODELS
LA618-2, LA618-4, LA618-5

- Step 1:** Accessories
Step 2: Plan hole distance, and drill 4 holes of 3.0mm ϕ and 1 hole of 10.0mm ϕ .
Step 3: Fasten clip and elevated parts of clip with screws.
Step 4: Fasten assembled clip kits in plastic rubber of ceiling with screws.
Step 5: Thread AC input wire of lamp through another side of ceiling.
Step 6: Thread screw through fixing hole of safety hole, then fasten it with clips kits.
Step 7: According above detailed figure, first snap one side on clip kits, then rotate it to install on another side of clip kits.
Step 8: Connect AC according mark on the input wire, then illuminate lamp, installation finish.

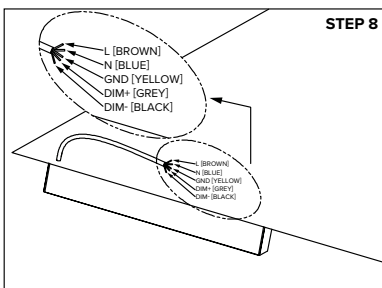
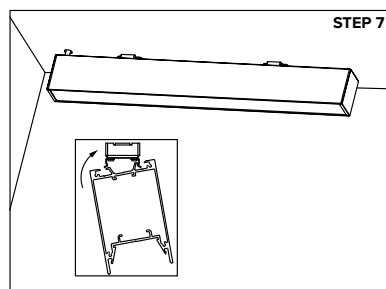
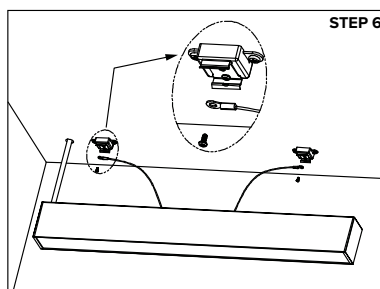
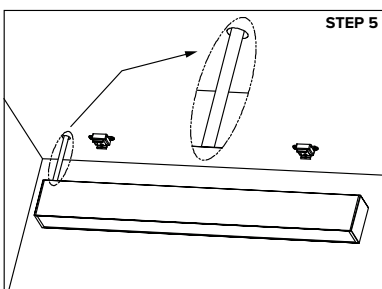
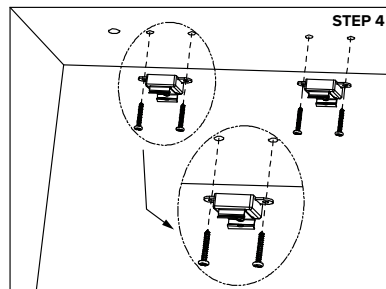
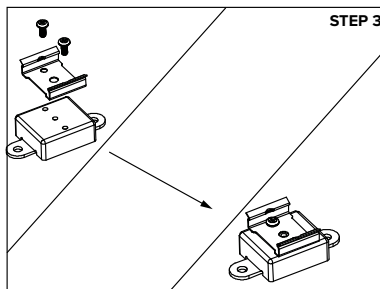
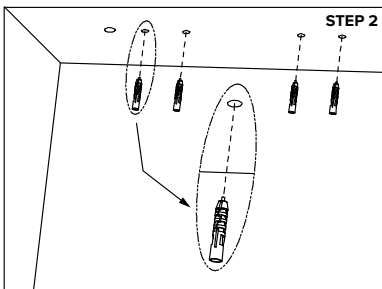
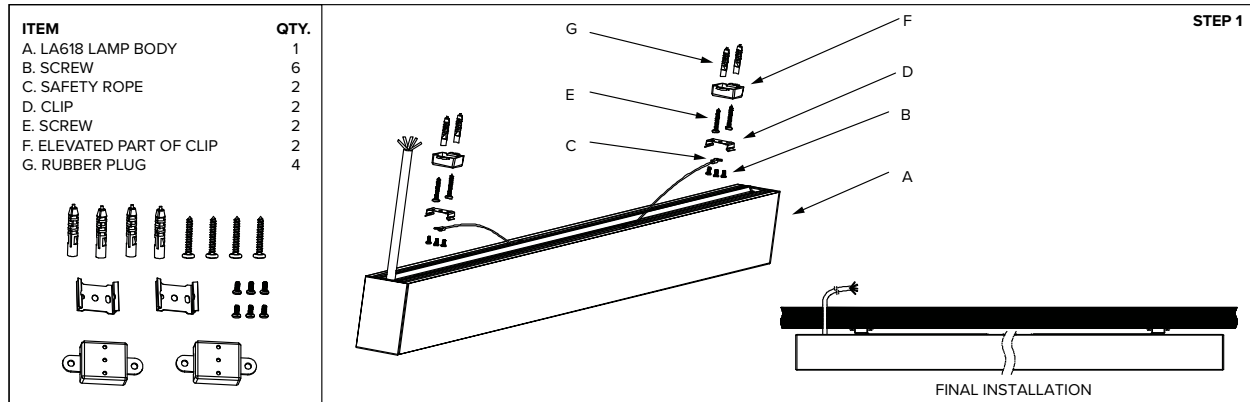

CONTINUOUS RUN INSTALLATION

APPLIES TO MODELS
LA618-2, LA618-4, LA618-5

Step 1: Accessories

Step 2: Snap AC input wire of lamp into U-Shape notch of connected section, then align fixing hole of connected section to fixing hole on lamp, finally fasten connected section and lamp with screws.

Step 3: Align fixing hole of other side to fixing hole of lamp tail, then fasten connection section and lamp.

Step 4: Installation finish.

ITEM	QTY.	ITEM	QTY.	ITEM	QTY.	STEP 1
A. LA618 LAMP BODY	1	B. CONNECTED SECTIONS (N-1)	1	C. SCREW (N-1)	8	

